

HA Series, Screw connection, 16 pin, Female insert

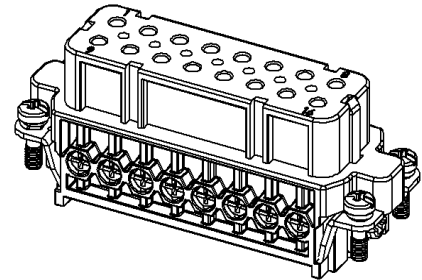
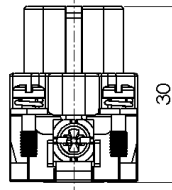
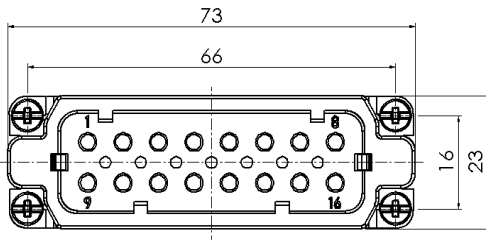

Typecode HA-016-F
ID 1 007 03 000010

Technical Data

Product Properties

| | |
|-------------------------------------|--|
| Series | HA |
| Mating with | H16A |
| Connection mode | Screw connection |
| Gender | Female |
| Rated voltage | 250 V |
| Rated current | 16 A |
| Rated impulse voltage | 4 kV |
| Number of pins | 16 |
| Core cross-section/Clamping ability | 1.0~ 2.5 mm ² / 18 AWG ~ 14 AWG |
| Grounding conductor | Yes |
| Pollution degree | 3 |
| Insulation resistance | ≥ 10 ¹⁰ Ω |
| Temperature range | -40 °C ~ +125 °C |
| Standard | EN 60664-1, IEC 61984 |

Insert

| | |
|----------|-----------------|
| Material | PC |
| Colour | Gray (RAL 7032) |

Commercial data

| | |
|-------------------|----------|
| Weight | 0.071 kg |
| Packaging unit | 10 pcs |
| Country of origin | CN |

Features

- High quality engineering plastics
- Screw connection
- ≥ 500 Mating cycles
- Approval: CE
- RoHS-compliant

*这里所列的是设计数据，有关产品的变更不在此做说明，未尽事宜请联系客服。用户有责任验证功能、符合适用的法律和指令以及在特定应用中的电气安全。