

HA Series, Crimping connection, 16 pin, Male insert

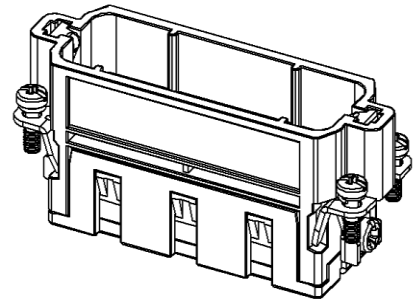
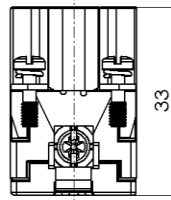
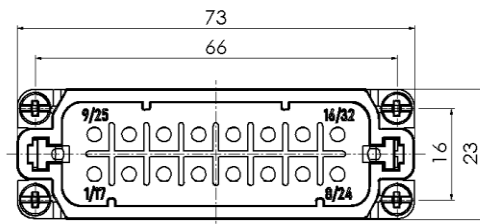

Typecode HA-016-MC
ID 1 007 03 000011

Technical Data

Product Properties

Series	HA
Mating with	H16A
Connection mode	Crimping connection
Gender	Male
Rated voltage	250 V
Rated current	16 A
Rated impulse voltage	4 kV
Mating contact series	16 A (ESM/EGM)
Number of pins	16
Core cross-section/Clamping ability	0.14~ 4 mm ² / 26 AWG ~ 12 AWG
Grounding conductor	Yes
Pollution degree	3
Insulation resistance	$\geq 10^{10} \Omega$
Temperature range	-40 °C ~ +125 °C
Standard	EN 60664-1, IEC 61984

Insert

Material	PC
Colour	Gray (RAL 7032)

Commercial data

Weight	0.039 kg
Packaging unit	10 pcs
Country of origin	CN

Features

- High quality engineering plastics
- Crimping connection
- ≥ 500 Mating cycles
- Approval: CE
- RoHS-compliant

*这里所列的是设计数据, 有关产品的变更不在此做说明, 未尽事宜请联系客服。用户有责任验证功能、符合适用的法律和指令以及在特定应用中的电气安全。