

## HDDD Series, Crimp Connection, 75 pin, Femle insert

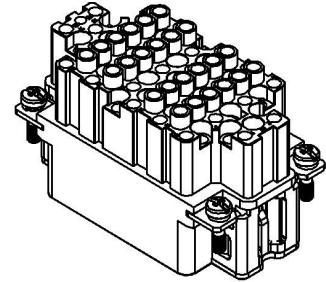
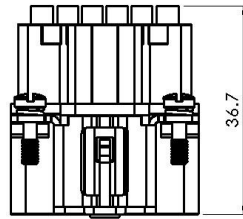
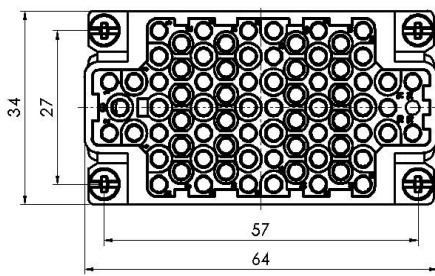

Typecode    HDDD-075-FC  
ID            1 007 03 0000152

### Technical Data

Product Properties	
Series	HDDD
Mating with	H10B
Connection mode	Crimp termination
Gender	Femle
Rated voltage	250V
Rated current	10A
Rated impulse voltage	4kV
Mating contact	10A(DSF/DGF)
Number of pins	75
Core cross-section/Clamping abilit	0.14 ~ 2.5 mm <sup>2</sup> /AWG26 ~ AWG14
Grounding conductor	Yes
Pollution degree	3
Insulation resistance	≥10 <sup>10</sup> Ω
Limiting temperature	-40°C~+125°C
Standard	EN 60664-1 IEC 61984

Insert	
Material	PC
Colour	RAL 7032

Commercial data	
Weight	0.053 kg
Packaging unit	1 pc
Country of origin	CN

### Features

- High quality engineering plastics
- Crimp termination
- ≥500 Mating cycles
- Approval: CE
- RoHS-compliant

\*这里所列的是设计数据，有关产品的变更不在此做说明，未尽事宜请联系客服。用户有责任验证功能、符合适用的法律和指令以及在特定应用中的电气安全。