

HE Series, Cage-Clamp, 10 pin, Male insert

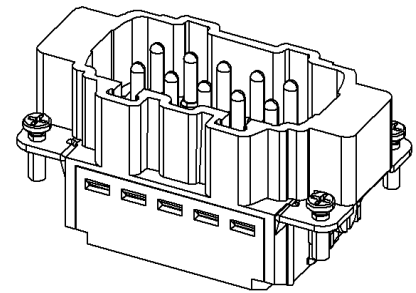
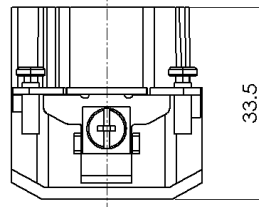
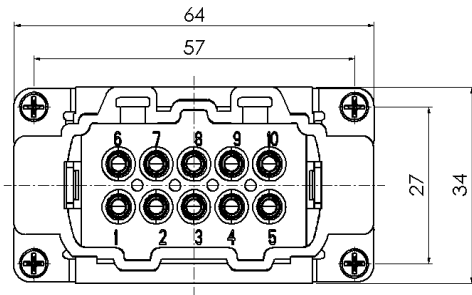

Typecode HE-010-MS
ID 1 007 03 000027

Technical Data

Product Properties

Series	HE
Mating with	H10B
Connection mode	Cage-Clamp
Gender	Male
Rated voltage	500 V
Rated current	16 A
Rated impulse voltage	6 kV
Number of pins	10
Core cross-section/Clamping ability	0.14~ 2.5 mm ² / 26 AWG ~ 14 AWG
Grounding conductor	Yes
Pollution degree	3
Insulation resistance	≥ 10 ¹⁰ Ω
Temperature range	-40 °C ~ +125 °C
Standard	EN 60664-1, IEC 61984

Insert

Material	PC
Colour	Gray (RAL 7032)

Commercial data

Weight	0.060 kg
Packaging unit	5 pcs
Country of origin	CN

Features

- High quality engineering plastics
- Cage-Clamp
- ≥ 500 Mating cycles
- Approval: CE, UL
- RoHS-compliant

*这里所列的是设计数据，有关产品的变更不在此做说明，未尽事宜请联系客服。用户有责任验证功能、符合适用的法律和指令以及在特定应用中的电气安全。