

## HM Series, Axial screw terminal,2 pin, Male module

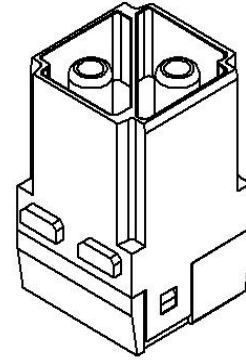
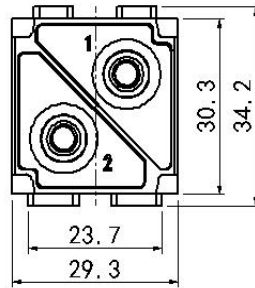
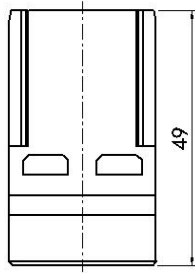

Typecode HM100-002-M-2

ID 1 007 04 000021

### Technical Data

#### Product Properties

Series	HM
Size of the module	module frames
Connection mode	Axial screw terminal
Gender	Male
Rated voltage	1000V
Rated current	100A
Rated impulse voltage	8KV
Number of pins	2
Core cross-section/Clamping ability	16 ~ 35mm <sup>2</sup> /AWG6 ~ AWG2
Pollution degree	3
Insulation resistance	≥ 10 <sup>10</sup> Ω
Temperature range	-40°C ~ +125°C
Tightening torque	10mm <sup>2</sup> @6Nm
	16mm <sup>2</sup> @6Nm
	25mm <sup>2</sup> @7Nm
Standard	EN 60664-1 IEC 61984

#### 材质

Material	PC
Colour	Gray (RAL 7032)
Contact material	Copper alloy siler plating

#### 商业数据

Weight	0.06kg
Packaging unit	1 pc
Country of origin	CN

### 特点

- 优质进口工程塑料
- 轴向螺栓连接
- 插拔次数 ≥ 500
- 通过CE,RoHS认证

\*这里所列的是设计数据，有关产品的变更不在此做说明，未尽事宜请联系客服。用户有责任验证功能、符合适用的法律和指令以及在特定应用中的电气安全。