

HM Series, Axial screw terminal, 2 pin, Female module

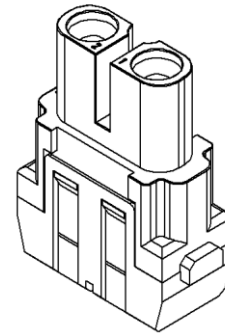
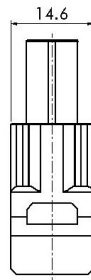
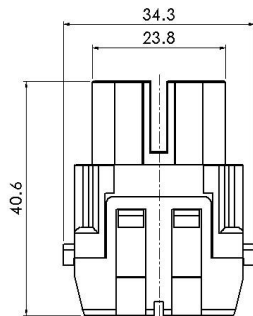

Typecode HM040-002-F-1

ID 1 007 04 0000036

Technical Data

Product Properties

| | |
|-------------------------------------|---|
| Series | HM |
| Size of the module | module frames |
| Connection mode | Axial screw terminal |
| Gender | Female |
| Rated voltage | 1000V |
| Rated current | 40A |
| Rated impulse voltage | 8KV |
| Mating contact series | 40A(CSF40/CGF40) |
| Number of pins | 2 |
| Core cross-section/Clamping ability | 6~ 10 mm ² /AWG10~ AWG8 |
| Pollution degree | 3 |
| Insulation resistance | ≥10 ¹⁰ Ω |
| Temperature range | -40°C~+125°C |
| Tightening torque | 2Nm@6mm ² 2Nm@10mm ² |
| Standard | EN 60664-1 IEC 61984 |

Insert

| | |
|----------|-----------------|
| Material | PC |
| Colour | Gray (RAL 7032) |

Commercial data

| | |
|-------------------|----------|
| Weight | 0.022 kg |
| Packaging unit | 1 pc |
| Country of origin | CN |

Features

- High quality engineering plastics
- Crimping connection
- ≥500 Mating cycles
- Approval: UL, CE
- RoHS-compliant

*这里所列的是设计数据，有关产品的变更不在此做说明，未尽事宜请联系客服。用户有责任验证功能、符合适用的法律和指令以及在特定应用中的电气安全。